



# VISUAL PRESENTER

## MO-1

---

<b>Quick Start Guide</b>	Make sure you read the "IMPORTANT SAFEGUARDS" in the Instruction Manual contained in the supplied CD-ROM before use.
--------------------------	--

---

# CONTENTS

---

<b>Let's get ready .....</b>	<b>3</b>
① Necessary items .....	3
② Setting Up .....	4
③ Connecting to a projector or a monitor .....	5
④ Connecting to a PC.....	5
<b>Let's use .....</b>	<b>6</b>
① Turn the power on/off .....	6
② Operating .....	6
• Adjusting the size and focus .....	6
• Adjusting the brightness .....	7
• Operating panel .....	7

# Let's get ready

## ① Necessary items

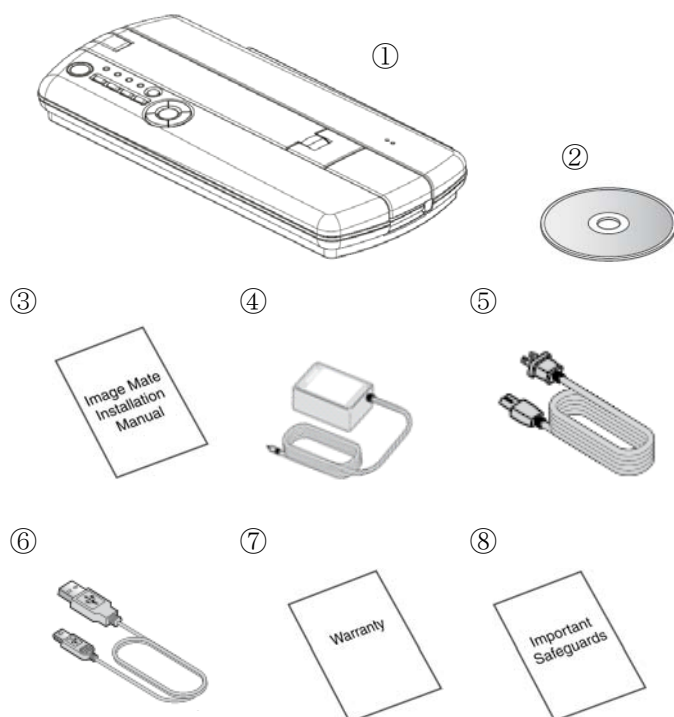

### Supplied items

① Mobile Document camera

② CD-ROM

(Image mate

/Instruction Manual

/Quick Start Guide)

③ Image Mate Instruction Manual

④ AC adapter

⑤ AC cord

⑥ USB cable

⑦ Warranty\*

\*for N. America only

⑧ Important Safeguards

### Composition of the instruction manual

Quick Start Guide-----Contains information on the basic operation of this product.

Instruction Manual-----Contains information on the operation and functions of this product.

Important Safeguards-----Contains important notes for the handling of this product.

---

## ②Setting Up

---

- ① Hooking your finger to the position indicated by an arrow in the drawing, slightly lift up the arm.

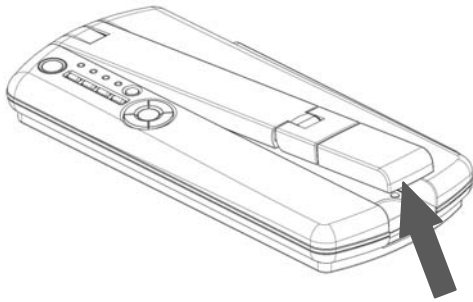

- ② Lift up the other side of the arm.

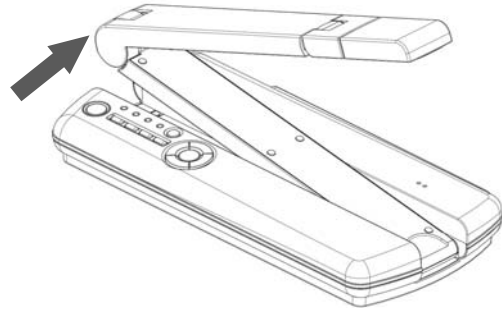

- ③ Move the arm in the direction indicated by an arrow.

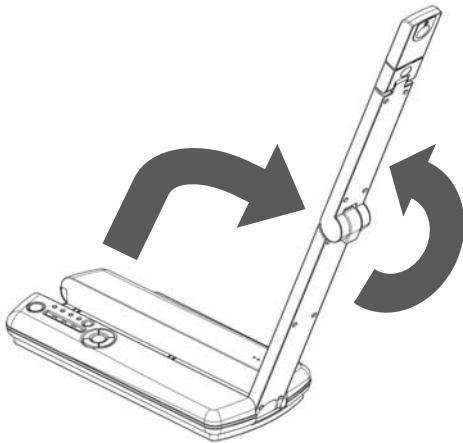

- ③ Move the camera head so that it is horizontal.

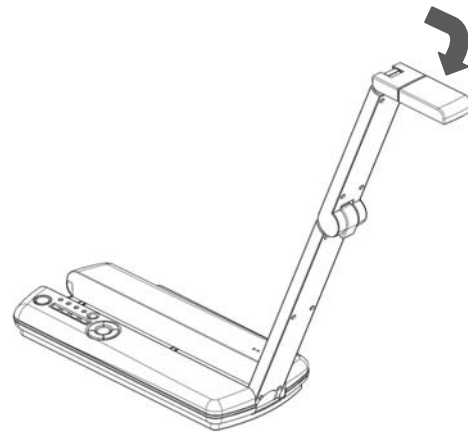

### CAUTION

When moving the arm, pay attention not to pinch your finger.

---

### ③Connecting to a projector or a monitor

---

#### ●Connecting with an RGB cable

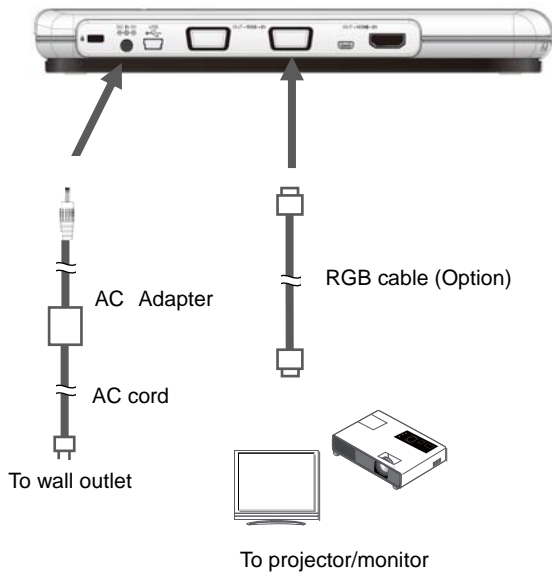

#### ●Connecting with an HDMI cable

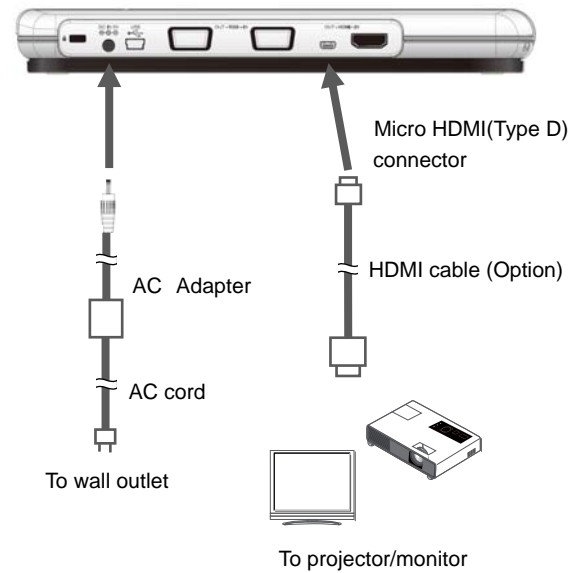

---

### ④Connecting to a PC

---

#### ●Connecting to the USB port

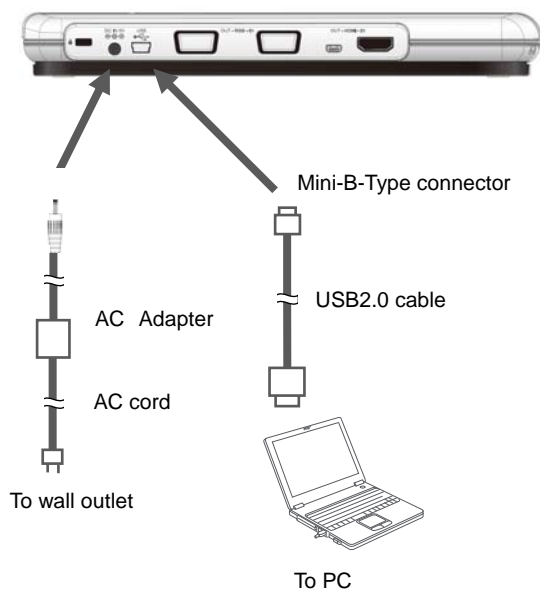

# Let's use

## ① Turn the power on/off

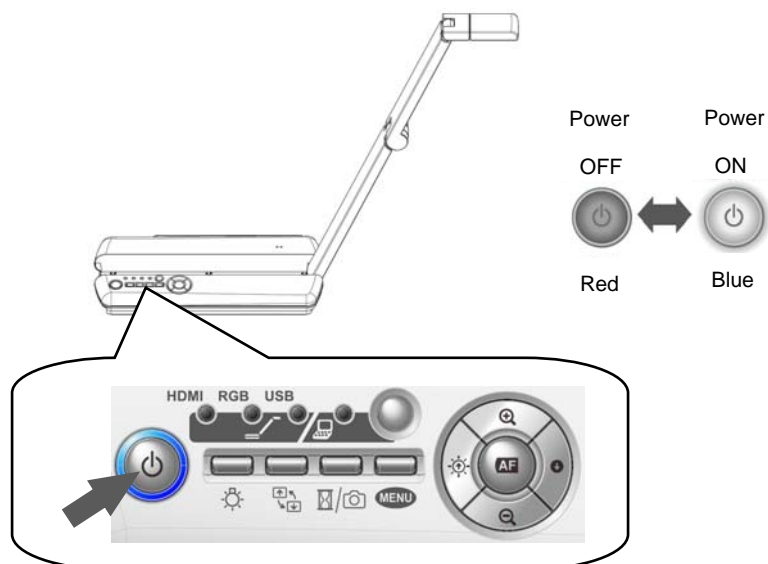

## ② Operation

### • Adjusting the size and focus

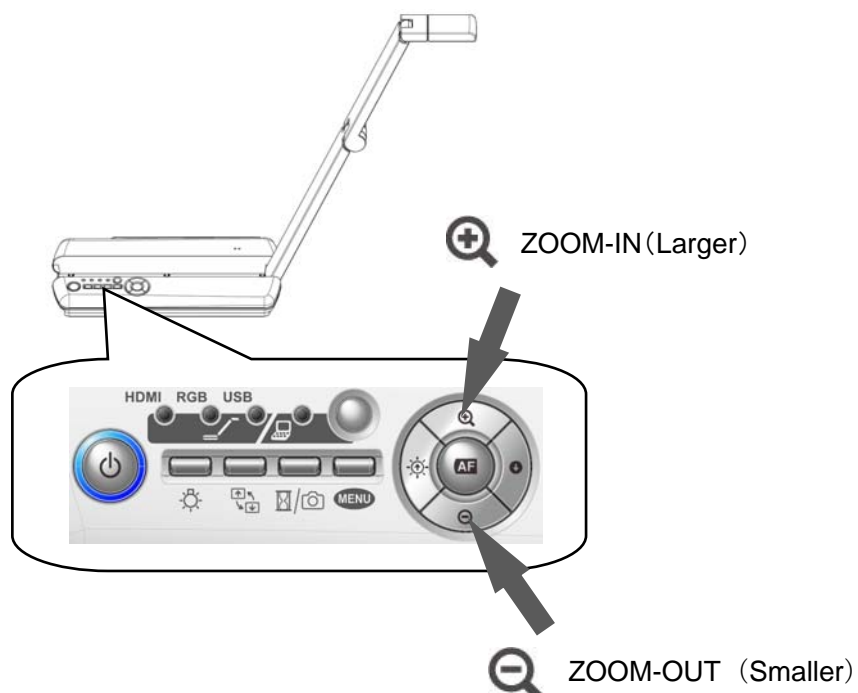

## • Adjusting the brightness

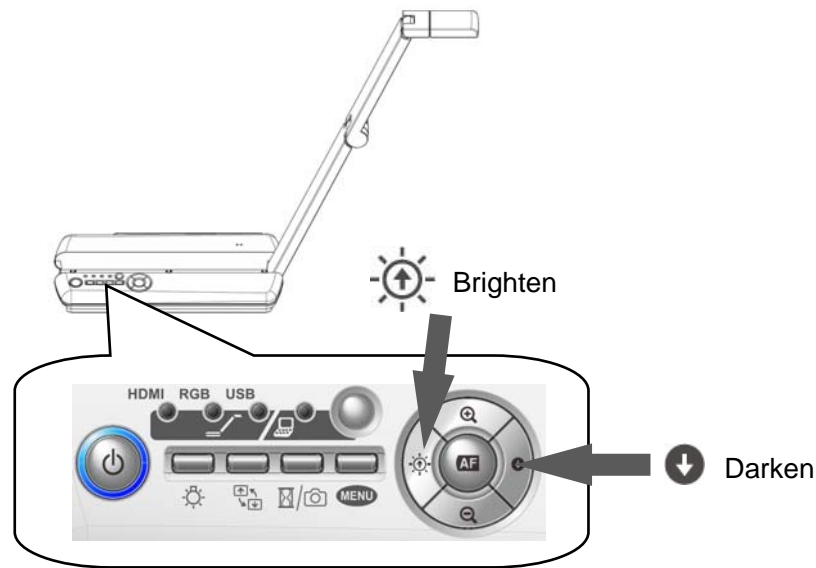

## • Operating panel

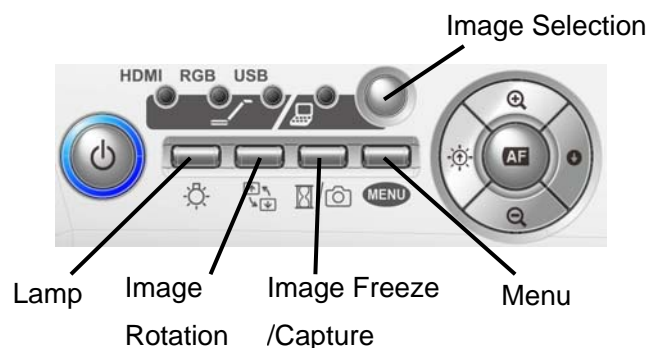

Mark	Name	Function
	Lamp	To turn the lamp ON/OFF
	Image Rotation	Camera Live image :Rotates by 180° Camera Still image: Rotates counterclockwise by 90°.
	Image Freeze /Capture	To pause the camera image by pressing this button for a short moment (less than 1 second). Press this button again to restart. To save a still image to the SD card by pressing this button for long (more than 1 second).
	Menu	To show/hide the menu on the screen.
	Image Selection	To switch the output video.

---

### WARNING

Unauthorized recording of copyrighted slide films, materials, photographs, etc. may infringe on the rights of copyright owners and be contrary to copyright laws.

---

## ELMO CO., LTD.

6-14, Meizen-cho, Mizuho-ku  
Nagoya, 467-8567, Japan

### OVERSEAS SUBSIDIARY COMPANIES

#### ELMO USA CORP.

Headquarters  
1478 Old Country Road  
Plainview, NY 11803-5034, U.S.A.  
Tel. (516) 501-1400 Fax. (516) 501-0429  
E-mail: [elmo@elmousa.com](mailto:elmo@elmousa.com)  
Web: <http://www.elmousa.com>

---

#### West Coast Branch

Cypress Pointe Business Park  
5676 Corporate Avenue  
Cypress, CA 90630, U.S.A.  
Tel. (714) 828-8457 Fax. (714) 828-8429

---

#### ELMO Europe SAS

Immeuble Elysées la Défense,  
7C, Place du Dôme,  
92056 Paris la Défense, France  
Tel. 33 (0) 1 73 02 67 06  
Fax. 33 (0) 1 73 02 67 10

6X1VHXAC5 R0-Xdx